

technical data type **SLIM**

Housing: White profiled housing with plastic endcaps.

Louvre: Single or double parabolic louvre available, fixed into the housing with a shoot bolt system

Types of louvres:

- double parabolic: LG 3 : Cat 2. (T8 or T5)
 - AB: bright anodized aluminium
 - AM: matt anodized aluminium

- asymeric : AB: bright anodized aluminium (T8 or T5)



Electrical specifications:

- ferromagnetic ballast and switch or electronic starters
- optional:
 - Parallel compensation.
 - HF or HFD ballast.
 - low loss ballast.
 - emergency module : 1 or 3 hours.



Louver with 4 shootbolts

Hingeable louvre

Lamps:

- fluorescent lamps (T8) in 18w -36w -58w.
- fluorescent lamps (T5) in 28w -35w.



Asymeric louvre



V09.12.2013



technical data type **SLIM**

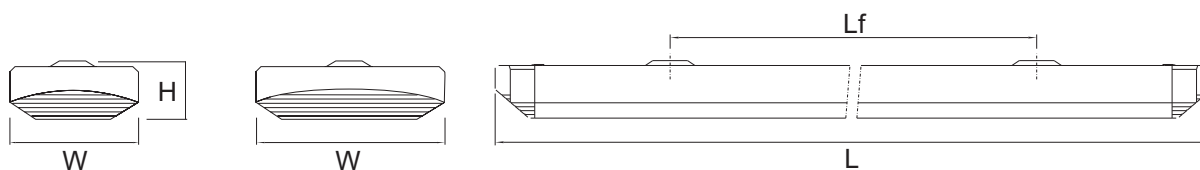

Slim T8	L	Slim T5	L	W	H	Lf	Kg	m3
1x 36W	1299	1x 28W	1254	170	75	650	3.7	0.018
1x 58W	1599	1x 35/49W	1554	170	75	800	4.9	0.022
2x 36W	1299	2x 28W	1254	255	75	650	5.6	0.027
2x 58W	1599	2x 35/49W	1554	255	75	800	7.3	0.033

SLIM DP AB Duo

Correction factors : 36W: 1.00 58W: 1.00

Polair Diagram

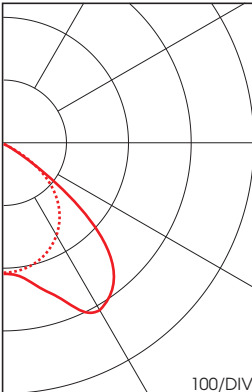

Utilisation Factors

Ceilings	.8	.7	.7	.5	.5	.5
Walls	.5	.5	.3	.5	.3	.3
Floor	.3	.1	.3	.3	.3	.1

Room ind. K

0.60	.42	.29	.25	.28	.24	.24
0.80	.48	.35	.31	.34	.31	.30
1.00	.52	.40	.36	.39	.35	.34
1.25	.55	.45	.41	.43	.40	.38
1.50	.58	.48	.44	.46	.43	.41
2.00	.61	.52	.49	.50	.48	.45
2.50	.62	.55	.52	.52	.50	.47
3.00	.64	.57	.54	.54	.52	.48
4.00	.65	.59	.57	.56	.54	.50
5.00	.66	.60	.58	.57	.55	.51

Glare Evaluation

2x3350 Im

Quality class	G	Service illuminance (Lux)				
A	1.15	2000	1000	500		
B	1.5		2000	1000	500	250
C	1.85			2000	1000	500

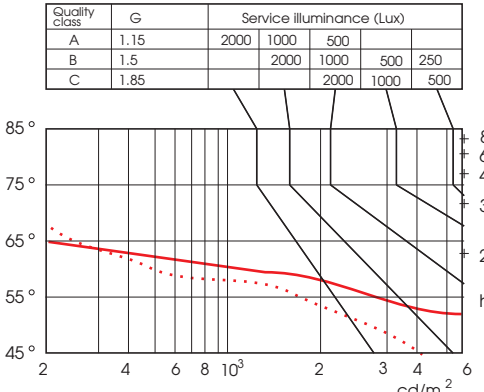

e/h : 1.77

Lum.Eff.: 52 % (η)

C.I.E.: 62 98 99 100 η

BZ3/1.00 B22

UTE : .52C

SLIM WH/WH Duo

Correction factors : 36W : 1.00 58W : 1.00

Polair Diagram

Utilisation Factors

Ceilings	.8	.7	.7	.5	.5	.5
Walls	.5	.5	.3	.5	.3	.3
Floor	.3	.1	.3	.3	.3	.1
Room ind. K						
0.60	.42	.28	.24	.28	.24	.23
0.80	.47	.34	.30	.33	.29	.28
1.00	.51	.39	.34	.37	.33	.32
1.25	.54	.43	.39	.41	.38	.36
1.50	.57	.46	.42	.44	.41	.39
2.00	.60	.51	.47	.48	.45	.43
2.50	.62	.54	.51	.51	.48	.45
3.00	.64	.56	.53	.53	.51	.47
4.00	.65	.59	.56	.55	.53	.49
5.00	.66	.60	.58	.57	.55	.49

Glare Evaluation

2x3350 lm

Quality class	G	Service illuminance (Lux)				
A	1.15	2000	1000	500		
B	1.5		2000	1000	500	250
C	1.85			2000	1000	500

e/h : 1.41

Lum.Eff.: 53 % (η)

C.I.E.: 56 86 97 100 η

BZ3

UTE : .53C

VLUX

Industrieweg Roosveld
3400 LANDEN BELGIUM

Tel + 32 11 88 09 00
Fax + 32 11 83 22 22

website www.vlux.com
ISO 9001 certified company

